

Feature :

SPST  
Mini in dimension

Application :

Consumer products  
Computer products  
Instrumentation  
Communication equipments



SWITCH SPECIFICATIONS	
POLE - POSITION	Momentary action , SPST
CONTACT RATING	MAX. : 12 V DC , 50 mA ; MIN. : 1 V DC , 50 $\mu$ A
CONTACT RESISTANCE	500 m $\Omega$ MAX. 5 V DC ; 10 mA , by Method of Voltage DROP
INSULATION RESISTANCE	100 M $\Omega$ MIN. 100 V DC for 1 minute
DIELECTRIC STRENGTH	Breakdown is not Allowable ; 250 V AC for 1 Minute
OPERATING FORCE	160 $\pm$ 50 gf
OPERATING LIFE	100,000 cycles
OPERATING TEMPERATURE RANGE	-40°C ~ 85°C
TOTAL TRAVEL	SHARP : 0.2 $\pm$ 0.10mm ; SOFT : 0.4 $\pm$ 0.10mm

**HOW TO ORDER**

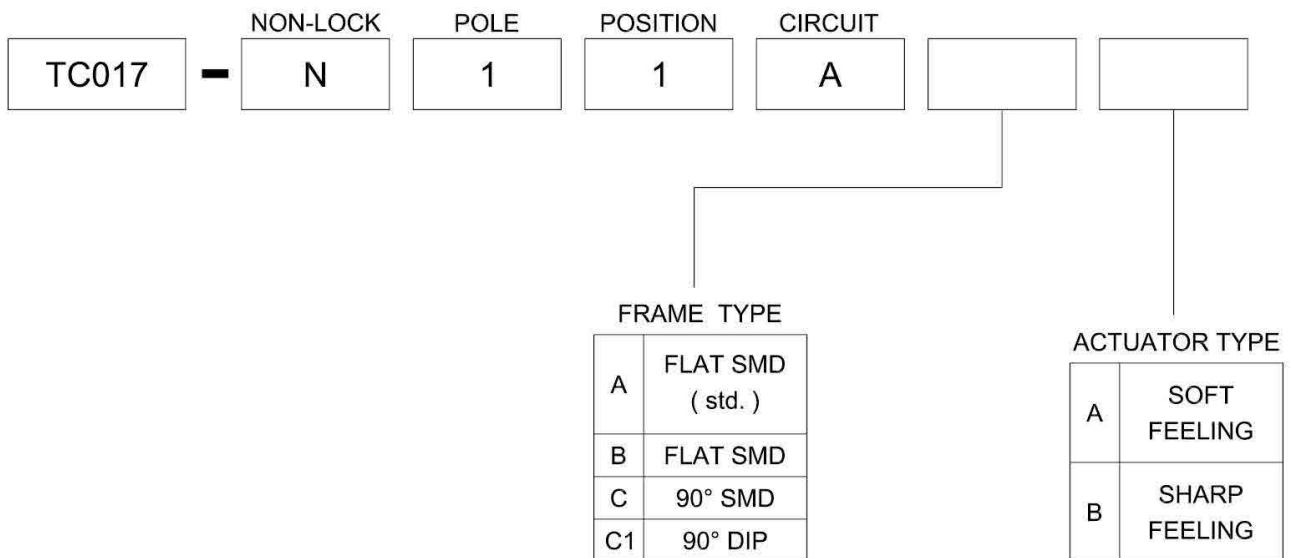

● FRAME TYPE

• TC017-N11AAA

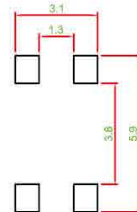
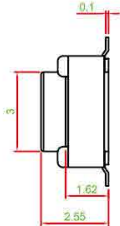
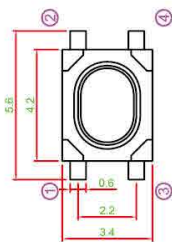

• TC017-N11ABB

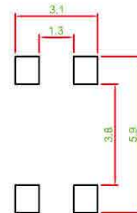
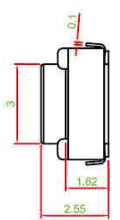
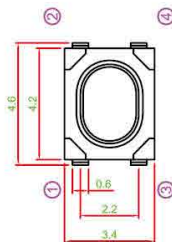

• TC017-N11ACA

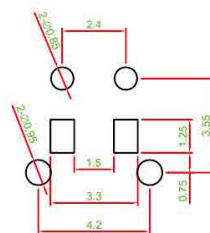
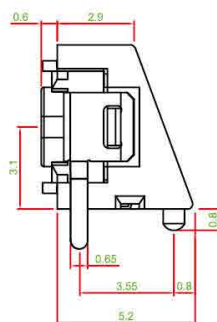
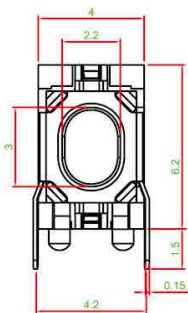

• TC017-N11AC1A

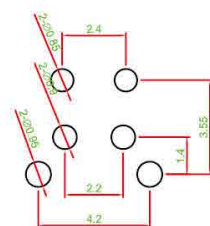
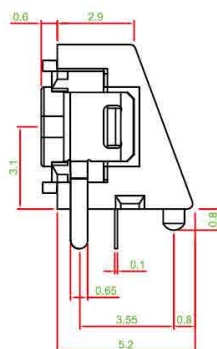
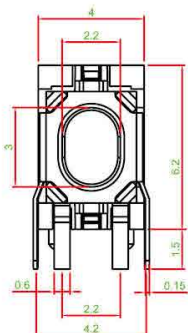

● CIRCUIT

